	Model specification	Emitted Color	Test voltage (V)	Current (mA) ±10%	Power (W) ±10%	Luminous flux(LM) ±25%	Color Temperature (K)	X,Y Coordinate/ Dominant wavelength	Light efficiency (LM/W)
	H7-2SMD3570-W-12VAC 8*43mil	White	13.5	1700	22.95	3000	7000	X:0.30~0.31 Y:0.32~0.33	130.7

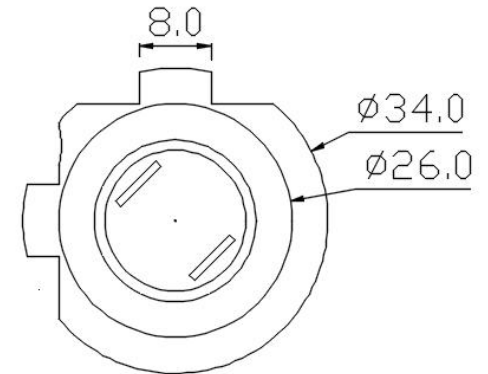

Description

- 1.Power supply: 12V
- 2.SMD3570,8*43MIL high power
- 3.Flip chip coated with package, the output of lumen is stable.
- 4.Efficient thermal conductivity.
- 5.High lumen output up to 3000LM.
- 6.Appearance Dimension:L58*T15mm

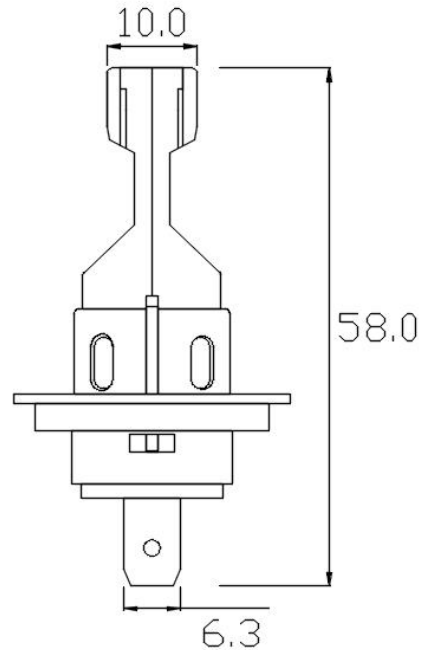
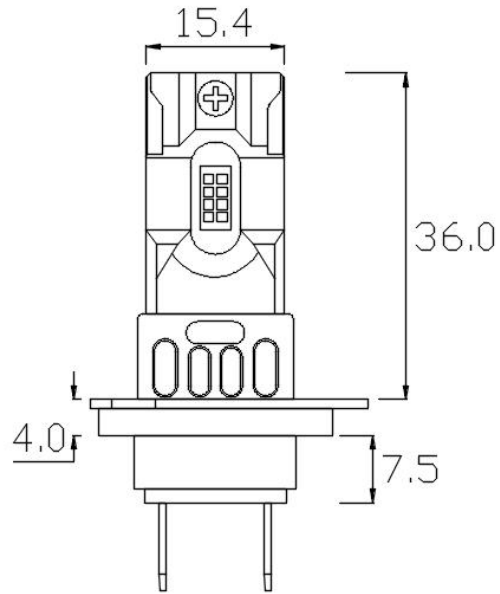

CHI MING ELECTRONICS CORP.		
Specifications	H7-2SMD3570-W-12VAC	
Date: 2025.04.07	Tab: QIU JUN	Admit: YE XUAN ZHI